



Northern Air Transport Association AGM



Yellowknife, NWT
April 29, 2015



Introduction

- 2014 progress update – Civil
- 2014 progress update - Building
- 2015 work - Building
- 2015 works phasing – Civil
- 30 day reduced runway length/width



2014 Progress Update - Civil

- Taxiway “A”
- Taxiway “G”
- ATB Foundation
- CSB Foundation
- Blasting/Crushing
- Drainage Improvements



2014 Progress - Building

- ATB Foundation
- CSB Foundation
- Fence Relocation

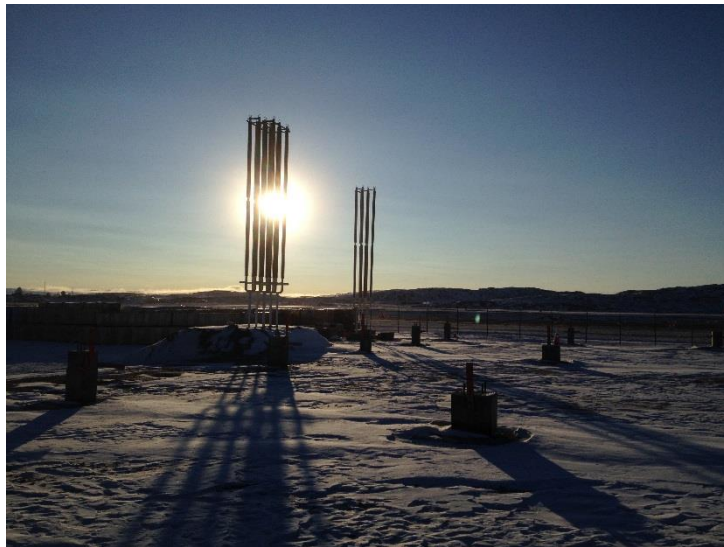

2015 Works - Building

- Backfill
- Concrete
- Steel Erection
- Building Envelope





2015 Works - Civil

- Runway: repair failed areas, leaving at least 6000'X100' available at all times
- Runway: first lift of asphalt on northern 2/3
- Apron 1 Extension: base and final lift of asphalt
- Taxiway A & G: base and final lift of asphalt
- Taxiway B: excavate, backfill, base and asphalt
- Airfield Lighting Replacement

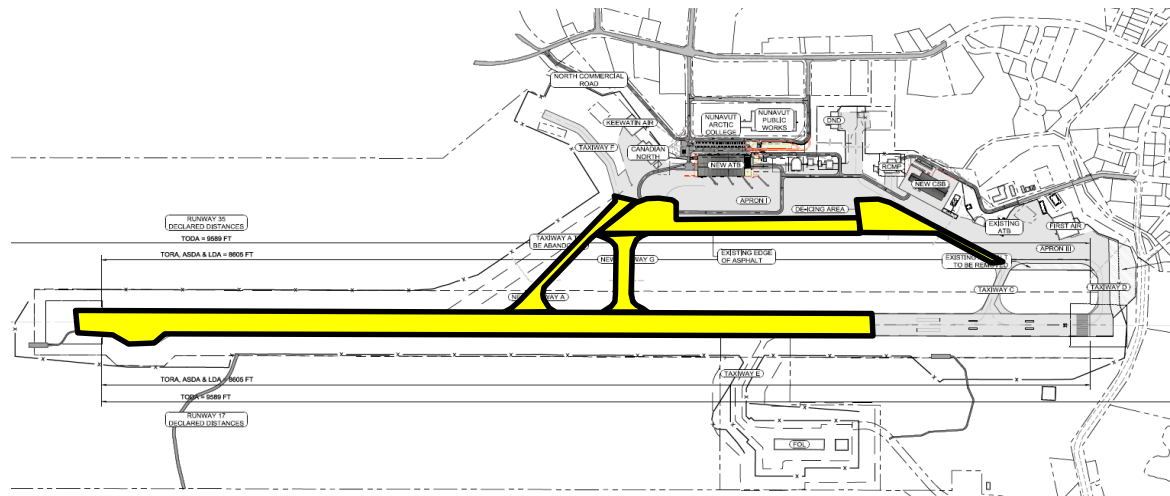



2015 Works - Civil

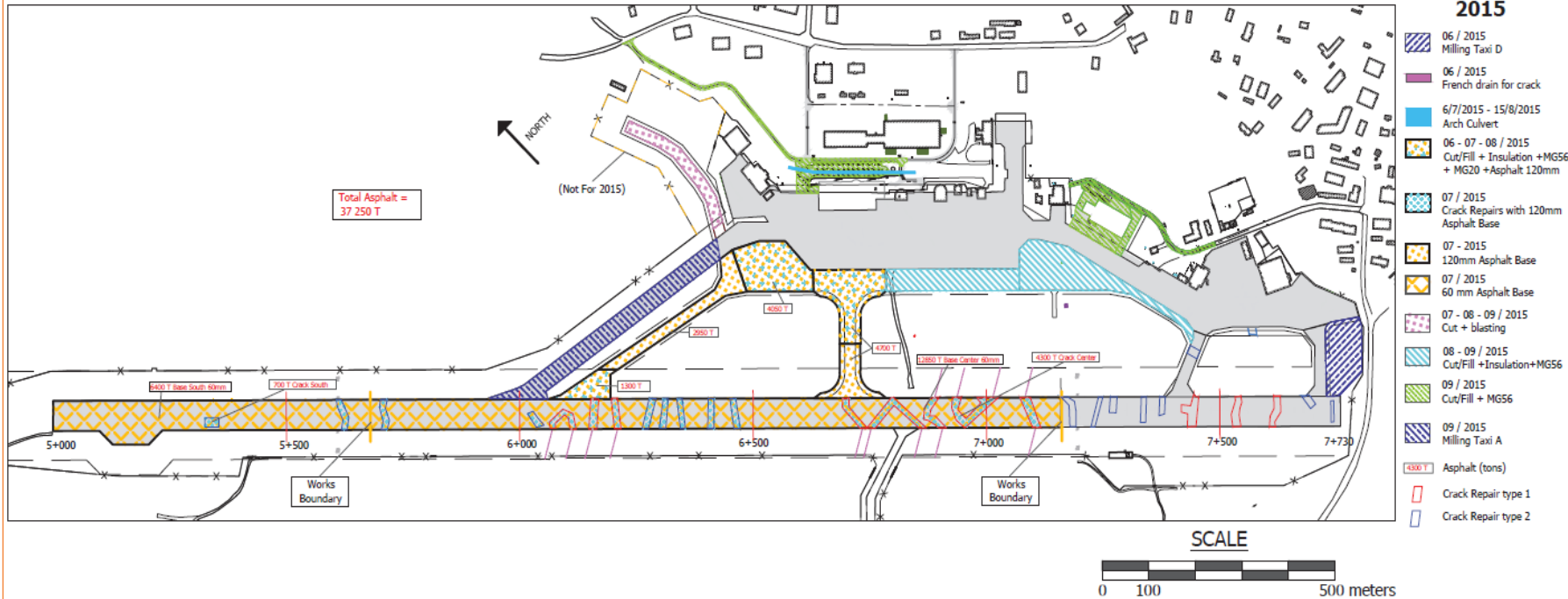

Major Crack Repair

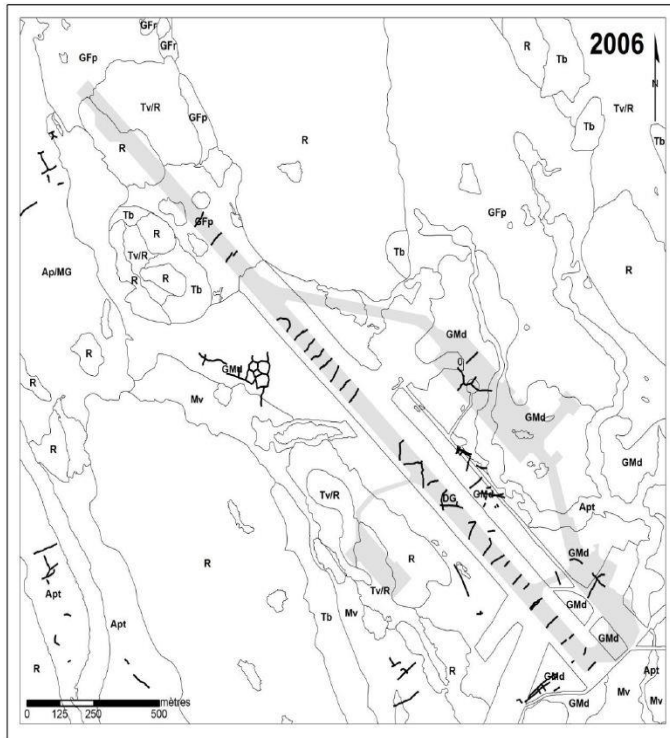

Figure 25 : Réseau de sillons de polygones de toundra les plus apparents pour la période de 2006, cartographiés à l'aide de l'image satellitaire QuickBird.

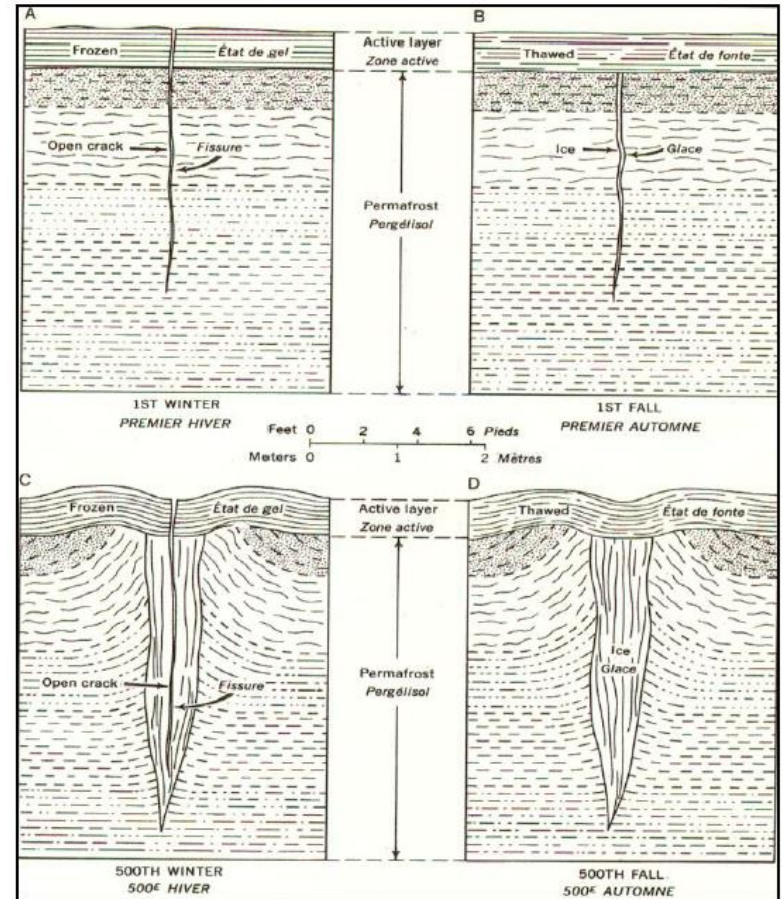
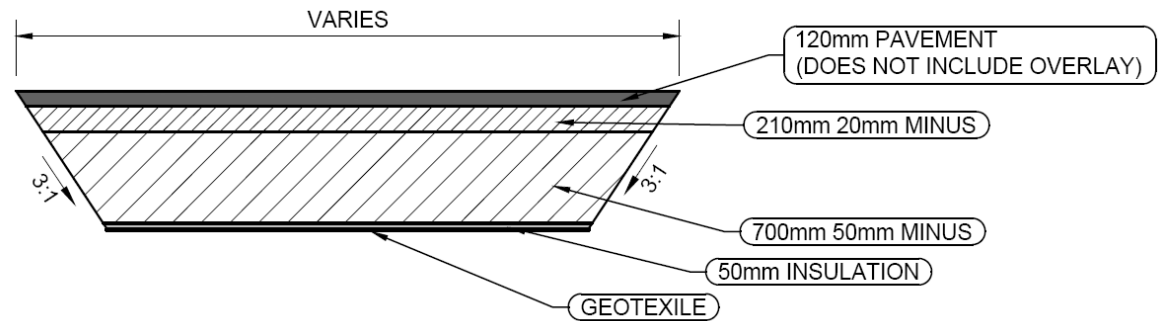
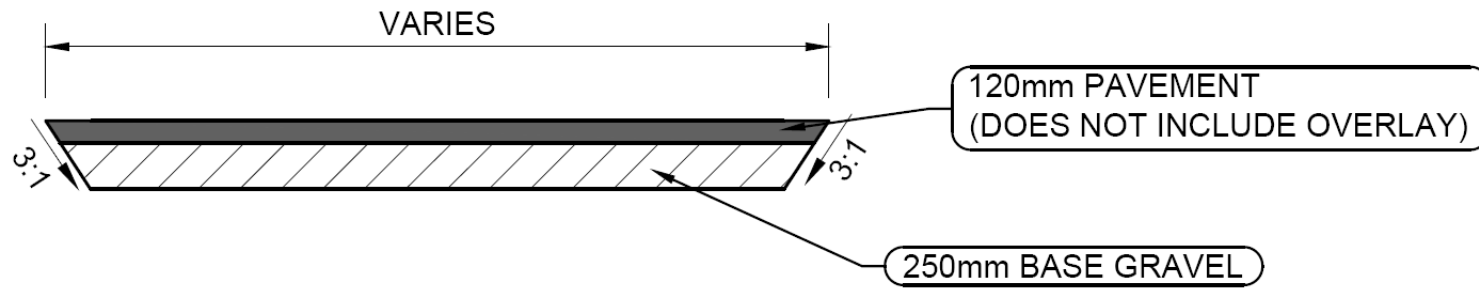
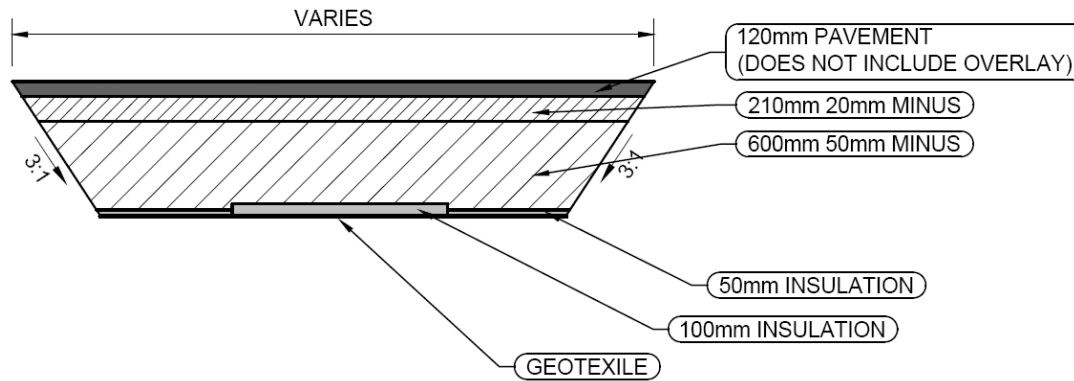
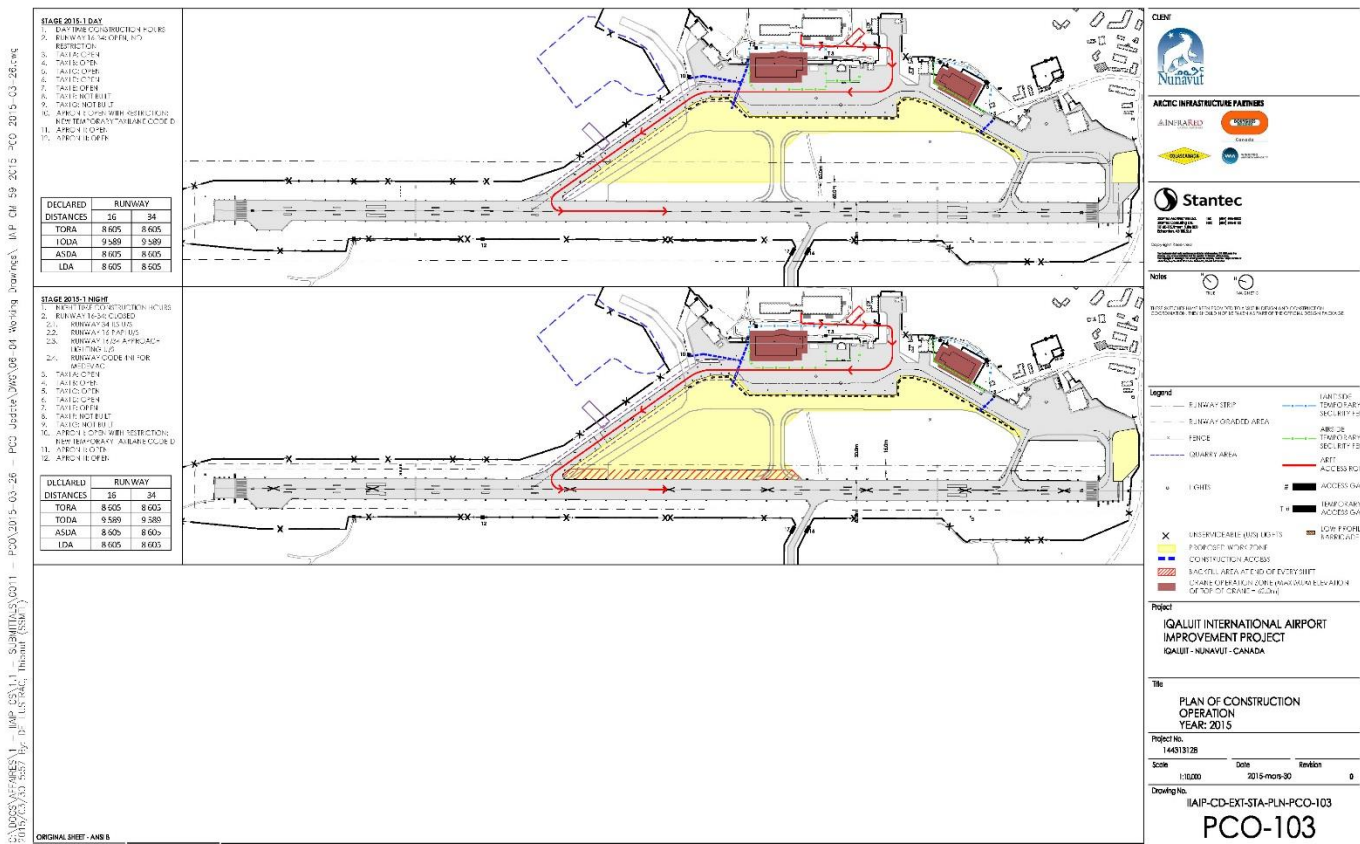

Figure 14: Étapes de formation d'un coin de glace (Lachenbruch, 1962)





Phase (1) June 1 to July 6





Communications

- NOTAMs and Voice Advisories will be issued as required
- NOTAM's will be pre arranged in collaboration with Nav Canada
- International NOTAMs issued for closure (ETOPS & Alternate)
- All Interested Parties will receive approved Plan of Construction



Questions?

Michael O’Gorman
Managing Director
mogorman@wasco.ca
<http://www.waa.ca/waa/wasco>

